

THE INFORMATION CONTAINED IN THIS DOCUMENT IS THE PROPERTY OF DMIPL AND IT SHALL NOT BE USED, REPRODUCED OR DISCLOSED TO OTHERS IN WHOLE OR IN PART WITHOUT THE EXPRESS PERMISSION OF DMIPL

ANY MANUAL ALTERATION WITHOUT AUTHORISED SIGNATURE SHALL AUTOMATICALLY RENDER THIS DRAWING INVALID

DEVIATION ON UNTOLERANCED DIMENSIONS IS:2102

DIMENSION	OVER								
	0.5	3	6	30	120	400	1000	2000	4000
	UP TO & INCL.								
MACHINE TOLERANCE	±0.1	±0.1	±0.2	±0.3	±0.5	±0.8	±1.2	±2	
FABRICATION TOLERANCE	±0.2	±0.3	±0.5	±0.8	±1.2	±2	±3	±4	

SURFACE FINISH SYMBOLS

ROUGHNESS SYMBOL	CYL. GRINDING	SUR. GRINDING	MACHINING	ROUGH MACHINING
ROUGHNESS VALUES Ra µm	0.8	0.8	3.2 6.3	25

ISSUE	DESCRIPTION	DATE	SIG
R1	Capacitor 2 mfd was 4 mfd, Power input 420 was 540 and Current 2.0 was 2.5	18-12-19	SSK

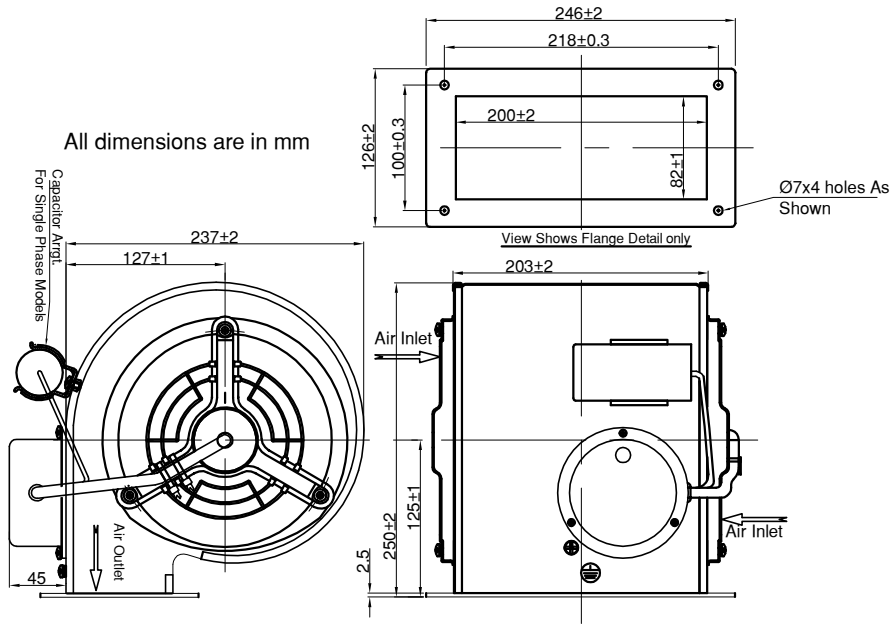

Model	Supply	Full Open Air output m³/Hr ±10 %	Shut Off Static Pressure mmwc ±10%	power Input max W ±10%	Current A ±10%	Speed RPM ±5%	Inlet Air Temp Max °C	Cap Value Mfd	Noise Level dbA	Weight Kg
DB15S2	240V, 50 Hz, 1Ø	1200	48	420	2.0	2720	60	12	72	8.5
DB1512 S2	220V, 60 Hz, 1Ø	1200	60	720	3.6	3200	60	12	80	8.5
DB15S4	240/220V, 50/60 Hz, 1Ø	620	14	100/160	0.45/0.75	1400 /1650	60	2	58	8.5
DB15T2	415V/380, 50/60 Hz, 3Ø	1450 /1650	48 / 72	640/1000	1/1.6	2770/3200	50	-	72/80	10
DB15T4	415/440V, 50/60Hz, 3Ø	620	14	112	0.3	1400 /1725	60	-	58	8.5

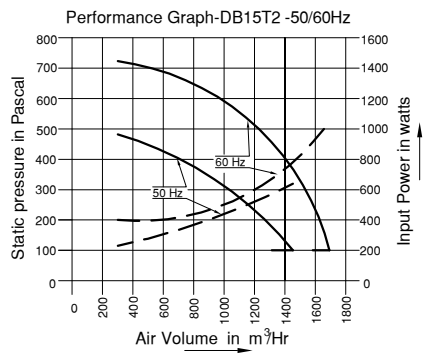
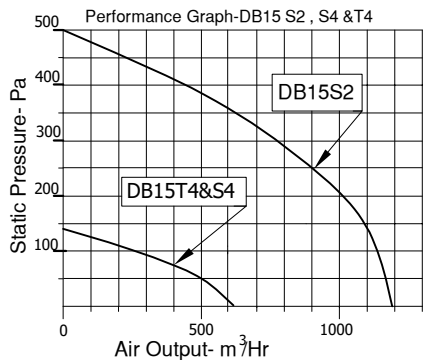

Vibration limit: Velocity-3.5 mm/sec rms as per ISO14694-2003, Table 4, BV3  
 Motor Insulation: Class F  
 List of Routine Tests Conducted:  
 1. Measurement of Winding Resistance.  
 2. Measurement of Parameter like, Input Power, Current, Speed and Vibration at  
 3. Withstand voltage test at 2200V(3Ø), 1500V(1Ø)  
 4. Insulation Resistance Test using 500V Megger.  
 The minimum insulation resistance shall be 5 MΩ.

Note:  
 \*Air Output And Pressure data are provided for Reference Only  
 \*Air output - Conversion to cfm: multiply "m³/hr" by 0.59  
 \*Static Pressure - Conversion to mmwc: divide "pascal" by 9.81  
 \*Due to continuous development, we reserve the right to modify the above details and specification without prior notice

DIM ( ) IS FOR REFERENCE ONLY		DEVIATION ON UNTOLERANCED DIMENSION ARE TO BE AS PER IS:2101-MEDIUM CLASS	
ALL DIMENSIONS ARE IN MM		FILE NAME : Specification DB15 (STD).dwg	SCALE - NTS FIRST ANGLE PROJ
DESIGNED BY	CHECKED BY	APPROVED BY	DATE:
	SSK	SSK	ISSUED DATE Date
<b>Dynamic Motors (India) Pvt. Ltd.</b> CHENNAI - 600 058, INDIA www.dynamicmotorsindia.com research@dynamicmotorsindia.com		SPECIFICATION DB15 (STD) DRG NO - DB15-201	
		REVISION R1	SHEET 1 of 1